

GRT720

BORSE LATERALI 25+25LT - SIDE BAGS 25+25LTRS - SACOCHES LATÉRALES 25+25 LITRES SEITENTASCHEN MIT 25 + 25 LITER
ALFORJAS LATERALES 25+25 LITROS - SACOS LATERAIS 25 + 25 LITRO



SIZES 400 210 400	VOLUME 25+ 25lt	UV TESTED 	REMOVABLE BRY-PACK IPX5 	MODULAR 	INNER POCKET 	ANATOMIC GRIP 	BELTS WITH CLIPS 	REFLECTIVE
-----------------------------------	--	----------------------	--	--------------------	-------------------------	--------------------------	-----------------------------	-----------------------



GRT720

BORSE LATERALI 25+25LT - SIDE BAGS 25+25LTRS - SACOCHES LATÉRALES 25+25 LITRES SEITENTASCHEN MIT 25 + 25 LITER
ALFORJAS LATERALES 25+25 LITROS - SACOS LATERAIS 25 + 25 LITRO

MOUNTING ON PL _

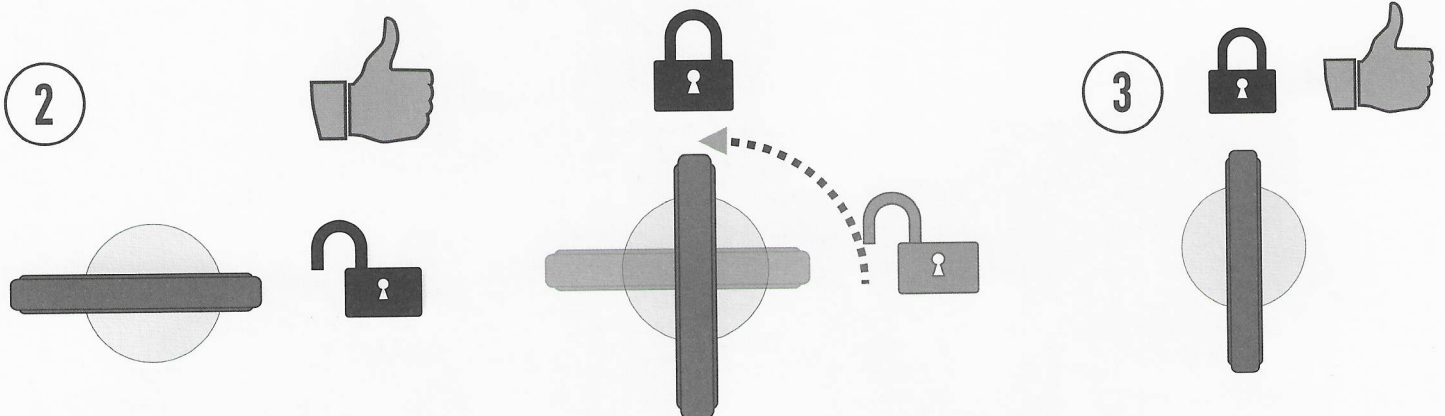
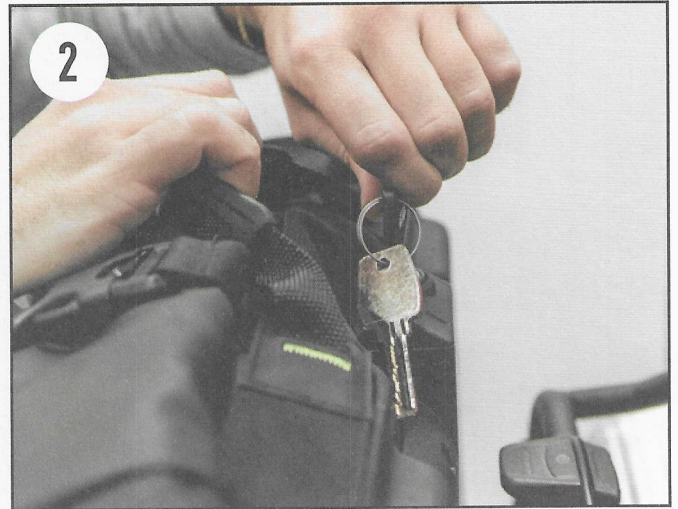

Ripetere la stessa operazione sul lato opposto della moto.
Repeat the same operation on the opposite side of the motorcycle.
Répétez la même opération sur le côté opposé de la moto.
Wiederholen Sie den gleichen Vorgang auf der gegenüberliegenden Seite des Motorrads.
Repita a mesma operação no lado oposto da motocicleta.
Repite la misma operación en el lado opuesto de la moto.

GRT720

BORSE LATERALI 25+25LT - SIDE BAGS 25+25LTRS - SACOCHES LATÉRALES 25+25 LITRES SEIDENTASCHEN MIT 25 + 25 LITER
ALFORJAS LATERALES 25+25 LITROS - SACOS LATERAIS 25 + 25 LITRO

ROLL TOP CLOSURE

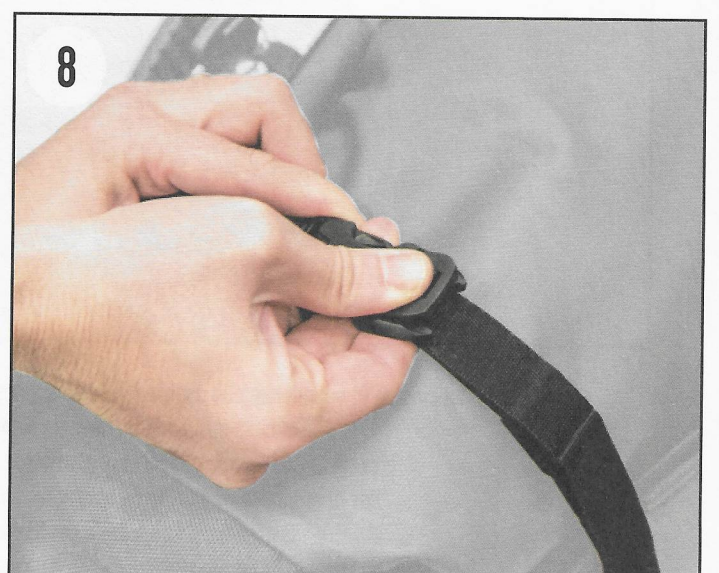
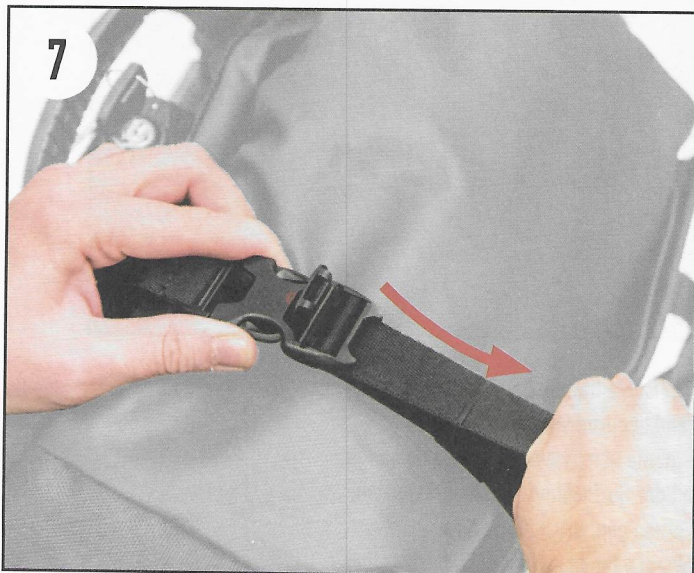
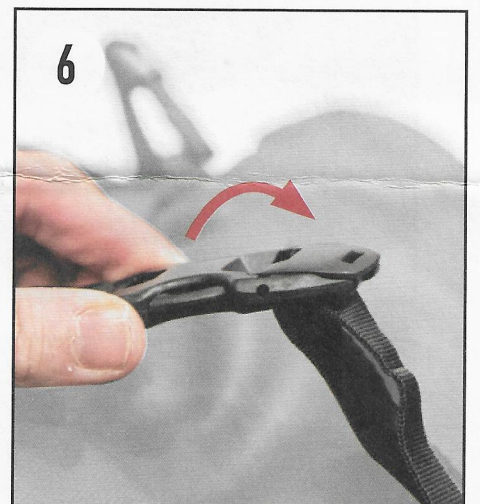
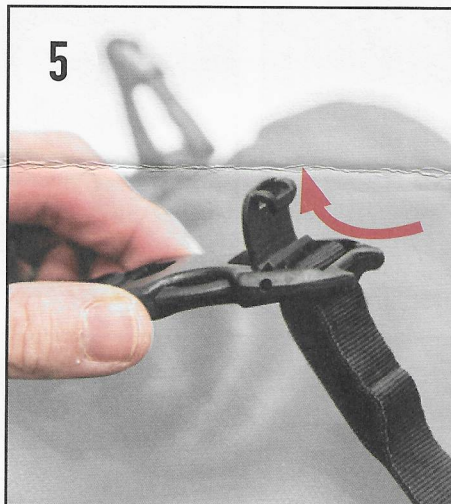
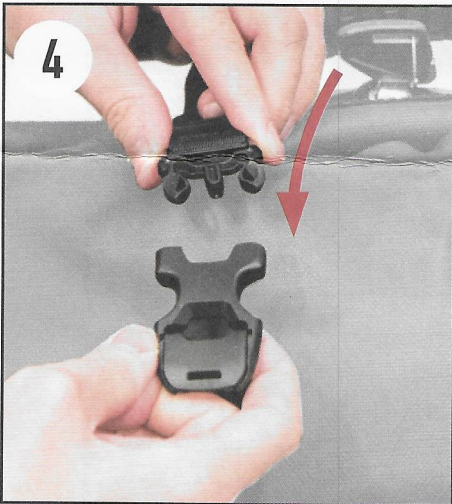

GRT720

BORSE LATERALI 25+25LT - SIDE BAGS 25+25LTRS - SACOCHES LATÉRALES 25+25 LITRES SEITENTASCHEN MIT 25 + 25 LITER
ALFORJAS LATERALES 25+25 LITROS - SACOS LATERAIS 25 + 25 LITRO

BELTS WITH TEAR-OFF PACK CLOSURE

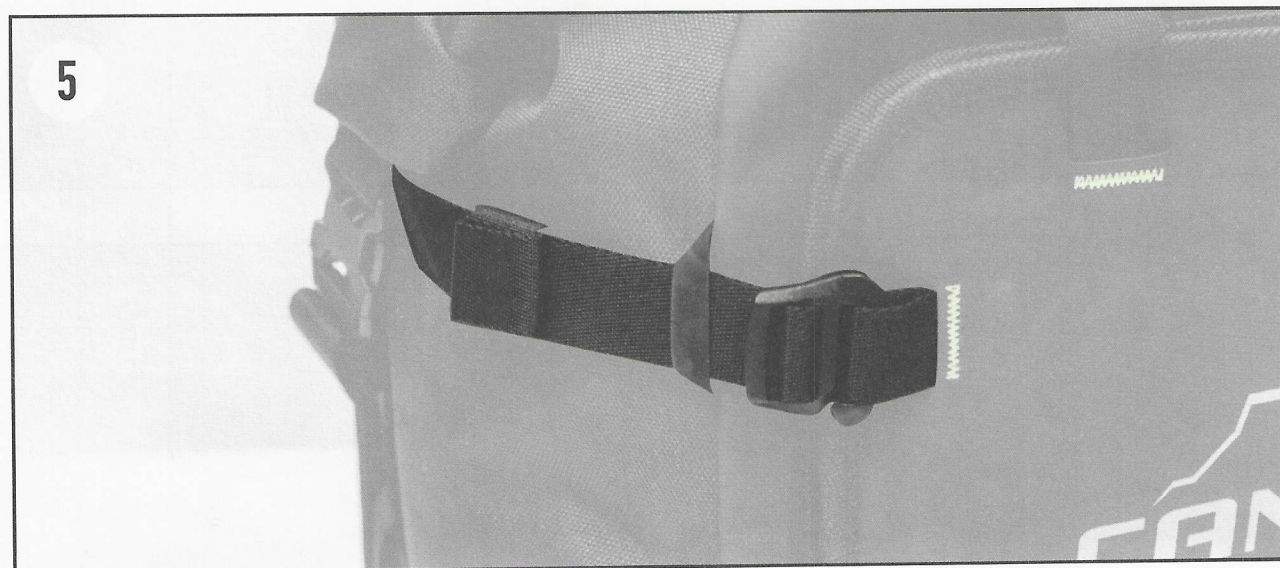
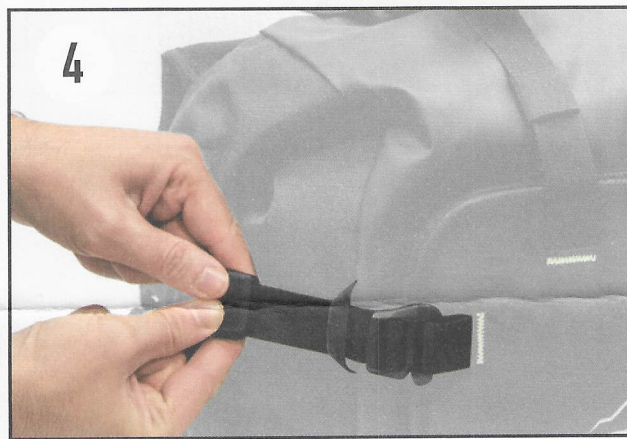
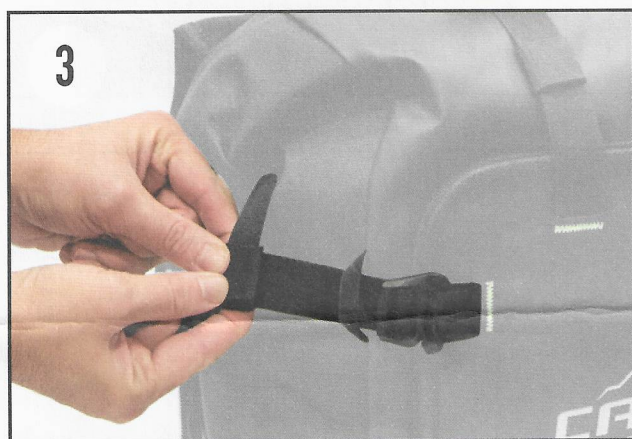
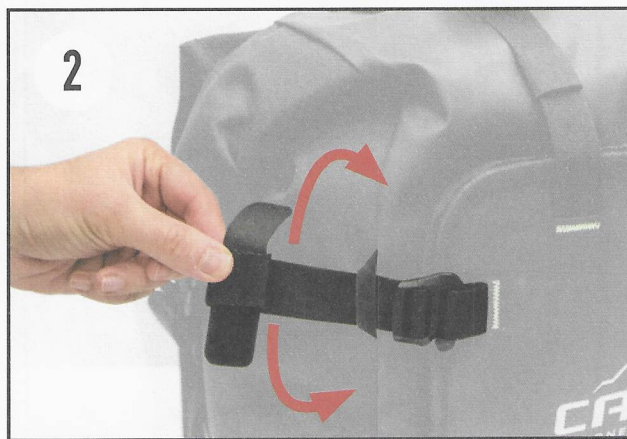
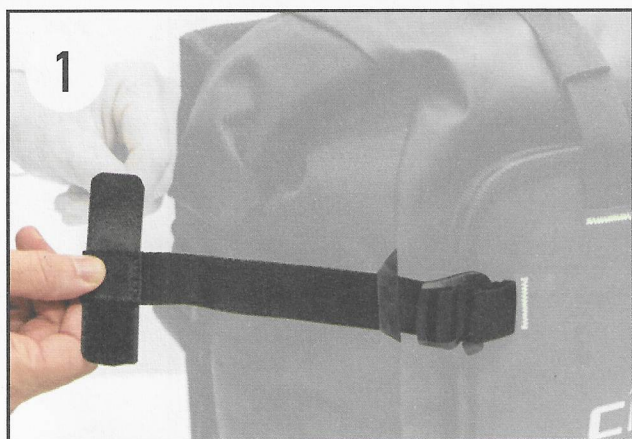

La cinghia in eccedenza può essere girata su se stessa e fissata tramite l'apposita chiusura a strappo.

The excess strap can be turned on itself and secured with the strap loop.

L'excédent de sangle peut être retourné sur lui-même et fixé avec la boucle de sangle.

Der überschüssige Gurt kann aufgerollt und mit der Gurtschleife gesichert werden.

O excesso de alça pode ser ligado e preso com presilha da alça.

La correa sobrante puede ser girada sobre sí misma y fijada en la hebilla de la correa.

GRT720

BORSE LATERALI 25+25LT - SIDE BAGS 25+25LTRS - SACOCHES LATÉRALES 25+25 LITRES SEITENTASCHEN MIT 25 + 25 LITER
ALFORJAS LATERALES 25+25 LITROS - SACOS LATERAIS 25 + 25 LITRO

MODULABLE WITH GRT722

GRT722 and its belts are not included

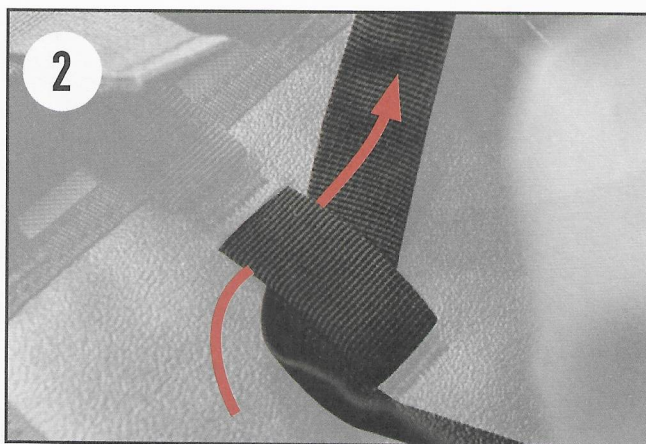
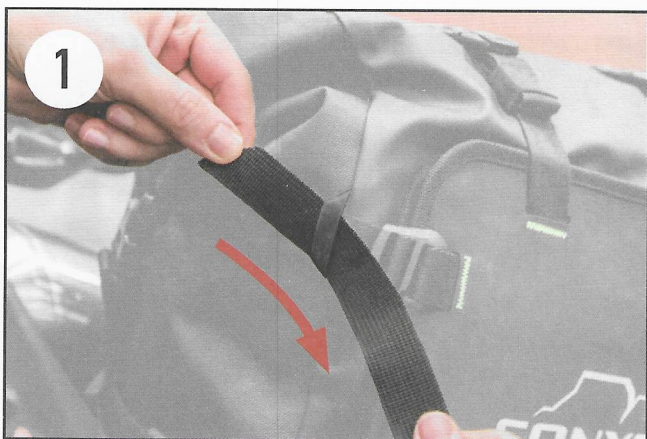

Far passare la cinghia sotto l'apposita asola.
Pass the strap under the strap loop.
Faites glisser la sangle sous la boucle.
Führen Sie den Gurt unter der Gurtschleufe hindurch.
Passe a tira sob a presilha da tira.
Desliza la correa por debajo de la hebilla de la correa.

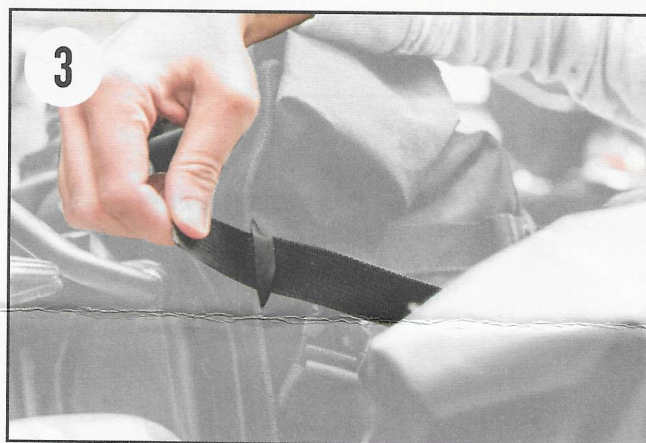

GRT720

BORSE LATERALI 25+25LT - SIDE BAGS 25+25LTRS - SACOCHES LATÉRALES 25+25 LITRES SEITENTASCHEN MIT 25 + 25 LITER
ALFORJAS LATERALES 25+25 LITROS - SACOS LATERAIS 25 + 25 LITRO

REMOVABLE INNER BAG

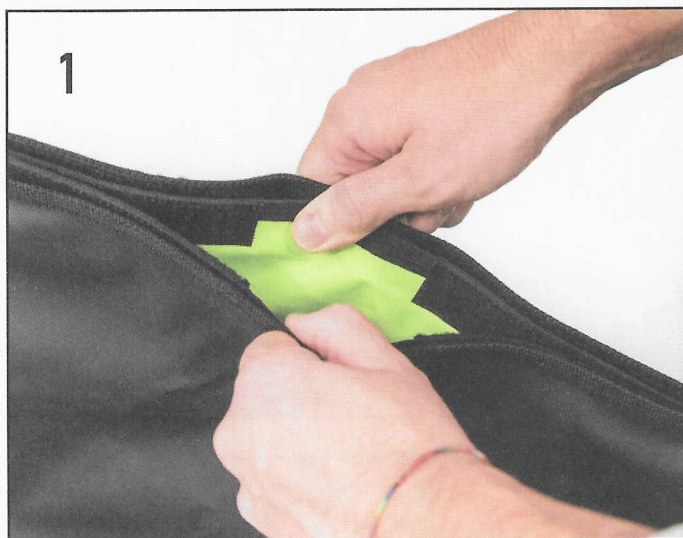

GRT720

BORSE LATERALI 25+25LT - SIDE BAGS 25+25LTRS - SACOCHES LATÉRALES 25+25 LITRES SEITENTASCHEN MIT 25 + 25 LITER
ALFORJAS LATERALES 25+25 LITROS - SACOS LATERAIS 25 + 25 LITRO

REMOVABLE FRONT FLAP

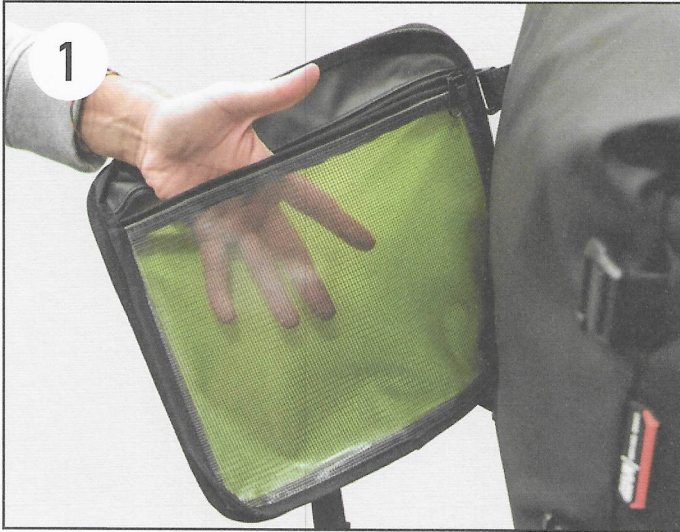

ISTRUZIONI DI MONTAGGIO - MOUNTING INSTRUCTIONS
INSTRUCTIONS DE MONTAGE - BAUANLEITUNG
INSTRUCCIONES DE MONTAJE - INSTRUÇÕES DE MONTAGEM

